



AudioFlex

W.Y.S.I.W.Y.G. SOUND SYSTEM

L'impianto e' a quattro vie ed e' composto da 24 elementi con una potenza effettiva di circa 8800w rms.

12 element con ciascuna un cono Fane colossus 15XB

ELECTRO ACOUSTIC SPECIFICATIONS :

Nominal Chassis Diameter 15"
Impedance 8 Ω
EIA 426A Power 800 w
Program Power 1600
Peak Power 6dB Crest Factor 3200
Frequency Range -3dB 40 Hz - 1.0 KHz
Sensitivity 1w - 1m 99 dB
Magnet Weight 126 oz
Magnetic Gap Depth 0.39" / 10 mm
Coil Diameter 4.0" / 102 mm
Flux Density (Tesla) 1.2
Coil Winding Length 0.90" / 23 mm
Coil Material Copper
Former Material Fibreglass

6 elementi sono di medio bassi con ciascuno un cono Fane sovereign 10-275

ELECTRO ACOUSTIC SPECIFICATIONS :

Nominal Chassis Diameter 10.00" / 254 mm
Impedance 8 Ω
EIA 426A Power 275 w
Program Power 550
Peak Power 6dB Crest Factor 1100
Frequency Range -3dB 45 Hz - 4 KHz
Sensitivity 1w - 1m 95 dB
Magnet Weight 56 oz
Magnetic Gap Depth 0.39" / 10 mm
Flux Density (Tesla) 1.02
Coil Diameter 2.5" / 63.5 mm
Winding Length 0.70" / 18 mm
Coil Material Copper
Former Material Fibreglass

4 elementi sono medio alti con ciascuno 4 conl sovereign 6-100

ELECTRO ACOUSTIC SPECIFICATIONS :

Nominal Chassis Diameter 6.50" / 165 mm
Impedance 8 Ω
EIA 426A Power 100 w
Program Power 200
Peak Power 6dB Crest Factor 400
Frequency Range -3dB 60 Hz - 10 KHz
Sensitivity 1w - 1m 93 dB
Magnet Weight 20 oz
Magnetic Gap Depth 0.23" / 6 mm
Flux Density (Tesla) 1.1
Coil Diameter 1.5" / 38.1 mm
Winding Length 0.39" / 10 mm
Coil Material Copper
Former Material Fibreglass

4 elementi sono tweeter composti ciascuno da un compression driver fane CD 280

ELECTRO ACOUSTIC SPECIFICATIONS :

Sound Channel / Throat Size 2" / 50.8 mm
Nominal Impedance 8 Ω
Power Handling (Watts AES) 80 W
Average Sensitivity 1W / 1m 108 dB
Usable Frequency Range (kHz) 800 Hz - 18 kHz
Recommended Crossover Frequency 1.6 kHz
Filtered at 18dB / octave
Effective Diaphragm Diameter 2.87" / 73 mm
Voice Coil Diameter 2.87" / 73 mm
Voice Coil DC Resistance 6.2 / 10.5 Ω
Max Diaphragm Displacement 0.032" / 0.8 mm
Flux Density 1.70 Tesla
Magnet Weight 60 oz / 1.72 kg

AMPLIFICAZIONE :

Per I bassi ci sono 6 finali crest da 900w rms per canale dando 450 w rms per cassa
Per I medio bassi ci sono 3 finali da 600w rms per canale dando 270 w rms per cassa
Per I medio alti ci sono 2 finali da 800w rms per canale danado 400w per rms per cassa
Per I tweeter c'e' un finale da 200 w rms per canale dando 80 w per cassa

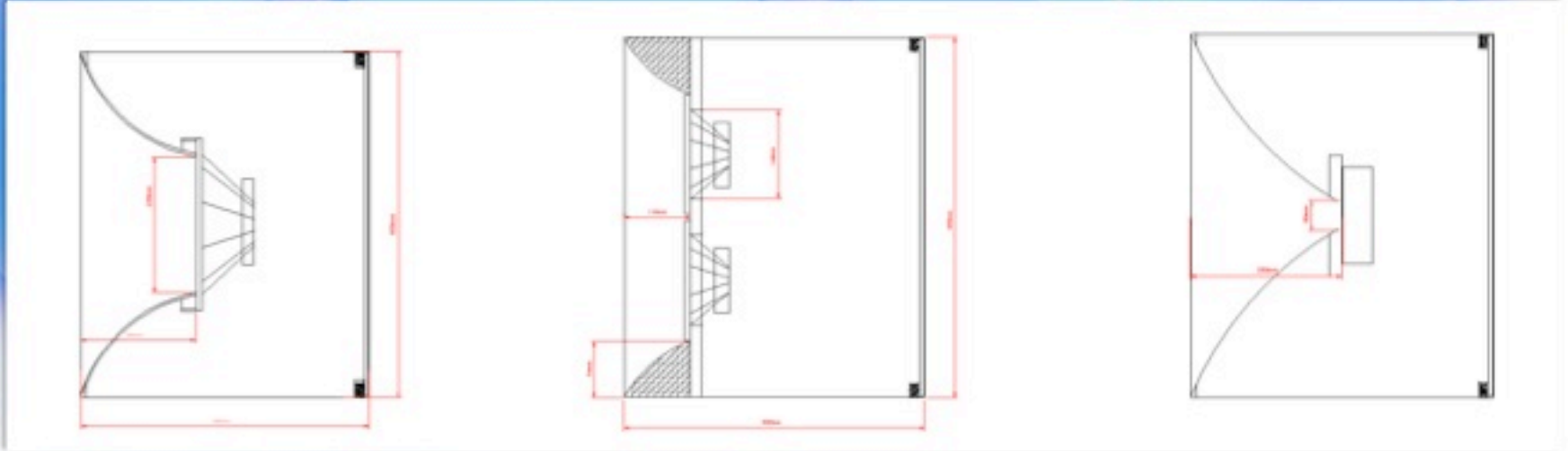
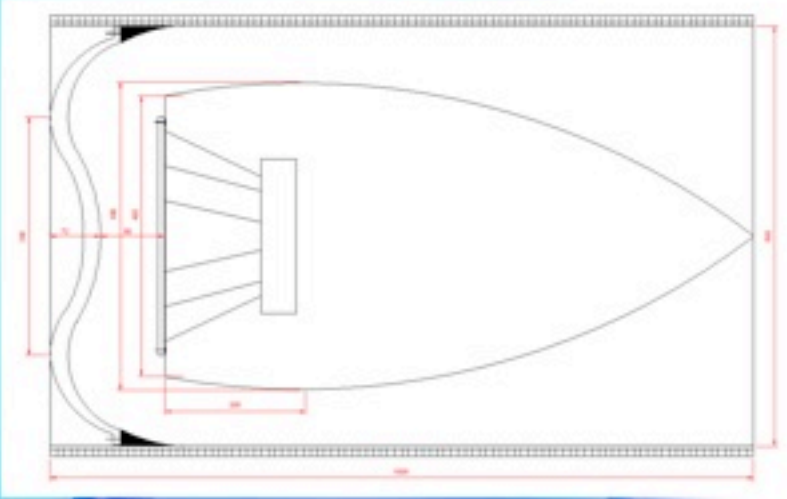
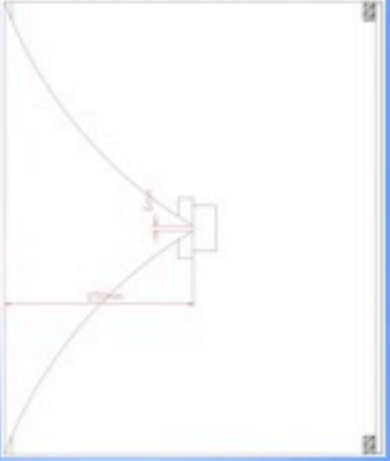







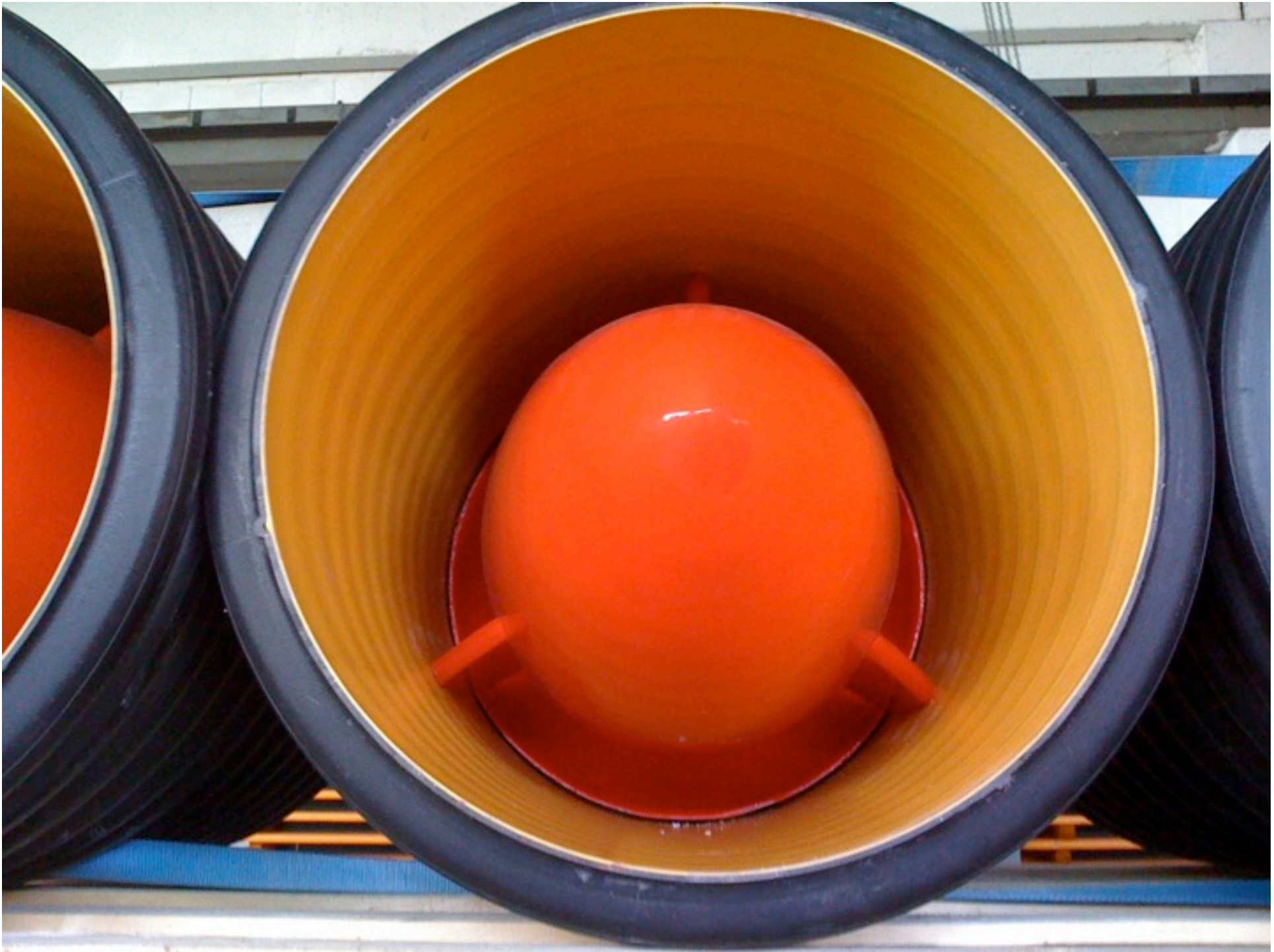

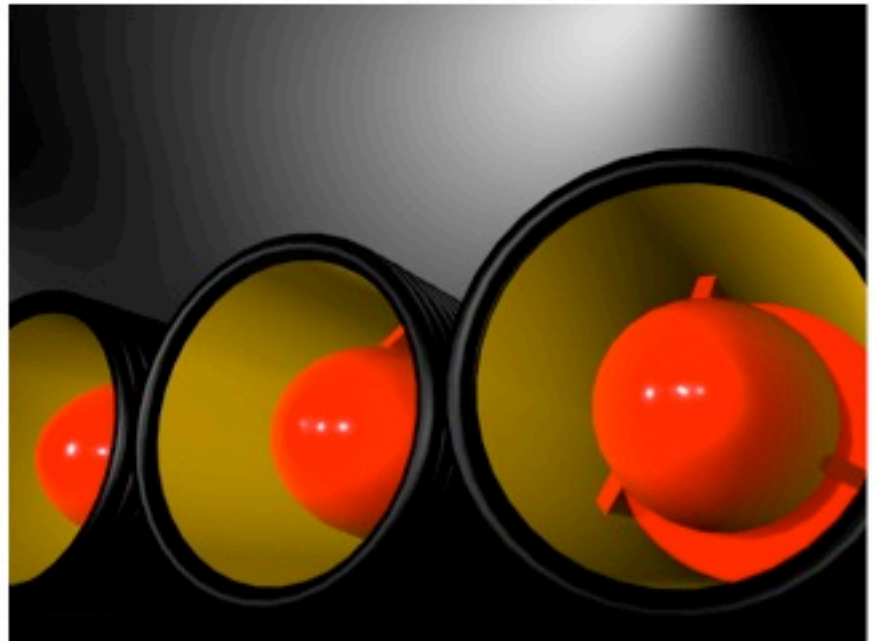
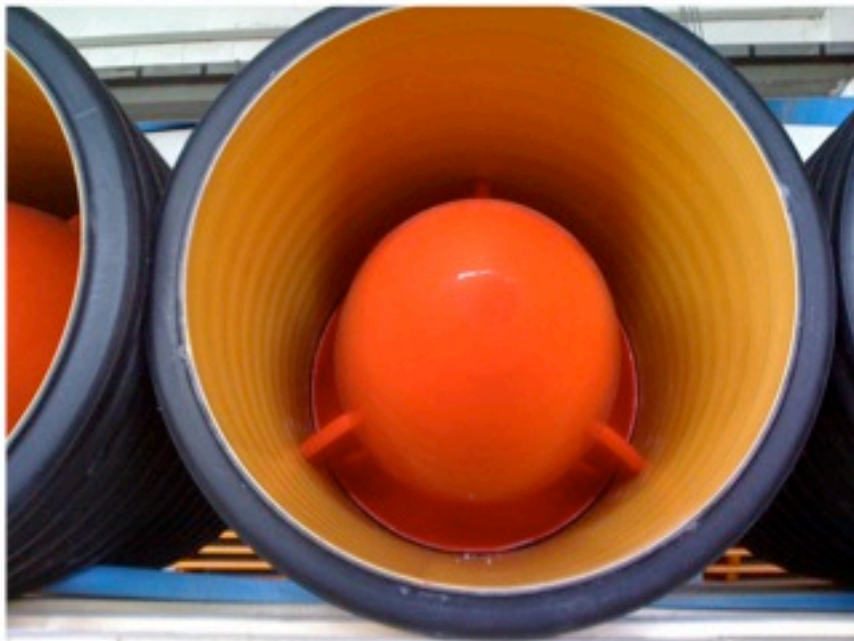
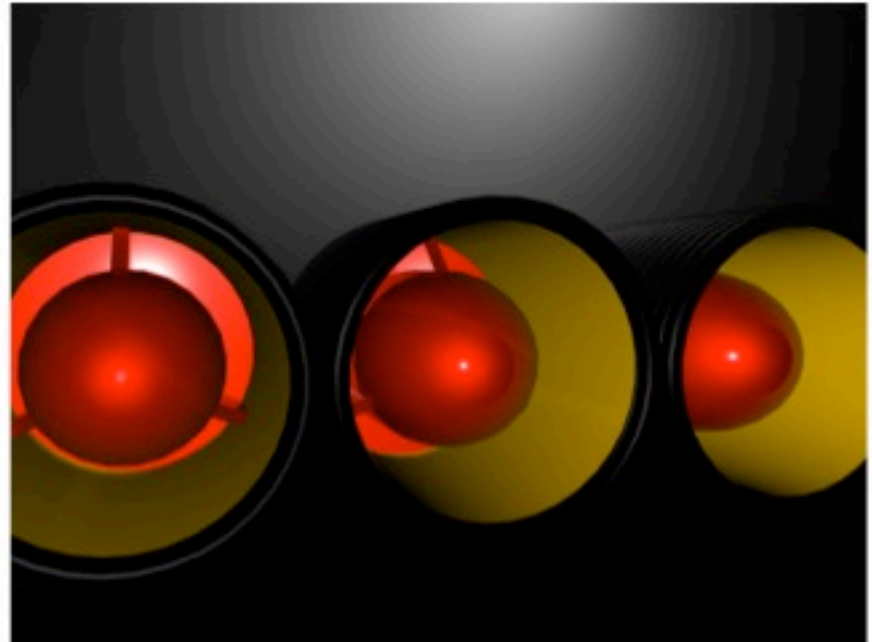
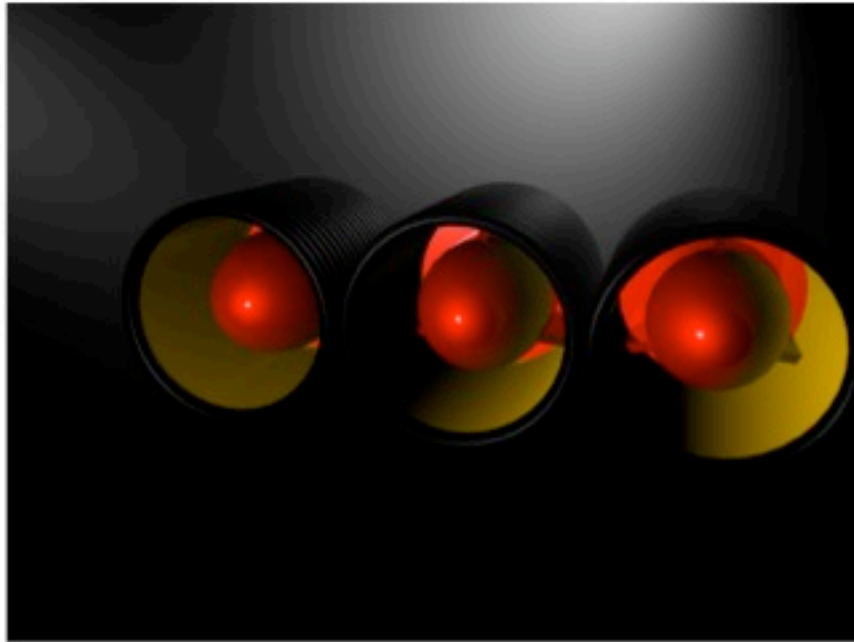

INFO CONTACTS:

FLEXSET

Di Samuel Wood
Via Bonfadini,101-20138 Milano
c.f. WDOSLL81E06Z114S
p.i. 06235030969
Flexset@gmail.com
[+393495318609](tel:+393495318609)

TEKSET

v.G.di Vittorio,9-20037
Paderno Dugnano (MI)
tel.+390291082905
fax.+390291088265
info@tekset.itwww.tekset.it